

## **LAMPIRAN**

## **LAMPIRAN**

## Demand overview table

CHILLER 18 DESEMBER 2018

Active Energy, forward	3,879	MWh
Active Energy, reverse	0,000	MWh
Total active energy	3,879	MWh
Max. demand	464,651*	kW
	18/12/2018	11:35:00

Cost of Energy

standard
  advanced

Total energy cost

**Rp4.022,98<sub>f</sub>**

Topology: 3-ph Wye  
 Start date: 18/12/2018 8:13:46  
 End date: 18/12/2018 17:13:46  
 Duration: 8h 59m 59s  
 Demand interval: 5min  
 Number of demand intervals: 109  
 Cost: 1,037Rp/kWh, fwd; 0Rp/kWh, rev  
 \* ... series contained partial intervals that have been discarded.

### Demand interval:

	Configured Interval length
CHILLER 18 DESEMBER 2018	5min

## V, A, Hz, THD overview table

CHILLER 18 DECEMBER 2018

CHILLER 18 DECEMBER 2018					Logging Information
<b>Voltage [V]</b>	<b>AN</b>	<b>BN</b>	<b>CN</b>	<b>N</b>	
<b>Max</b>	230,2 V 18/12/2018 17:13:46	232,0 V 18/12/2018 17:13:45	231,8 V 18/12/2018 17:12:16		Study type: <b>Energy study</b>
<b>Avg</b>	225,4 V	227,0 V	227,1 V		Topology: <b>3-ph Wye</b>
<b>Min</b>	221,1 V 18/12/2018 10:37:43	222,7 V 18/12/2018 10:37:43	222,9 V 18/12/2018 10:37:43		Start date: <b>18/12/2018 8:13:46</b>
<b>Current [A]</b>	<b>A</b>	<b>B</b>	<b>C</b>	<b>N</b>	End date: <b>18/12/2018 17:13:46</b>
<b>Max</b>	873,7 A 18/12/2018 11:11:58	915,0 A 18/12/2018 11:11:58	909,0 A 18/12/2018 13:23:30		Duration: <b>9h 0m 0s</b>
<b>Avg</b>	784,5 A	829,0 A	813,3 A		Averaging interval: <b>1sec</b>
<b>Min</b>	259,5 A 18/12/2018 16:59:53	280,8 A 18/12/2018 17:00:59	287,7 A 18/12/2018 17:04:12		Number of averaging intervals: <b>32400 (32400)</b>
<b>Frequency [Hz]</b>	<b>AN</b>				
<b>Max</b>	50,23 Hz 18/12/2018 9:30:21				
<b>Avg</b>	49,86 Hz				
<b>Min</b>	49,33 Hz 18/12/2018 10:40:17				
<b>THD-V [%]</b>	<b>AN</b>	<b>BN</b>	<b>CN</b>	<b>N</b>	
<b>Max</b>	1,4 % 18/12/2018 12:17:01	1,6 % 18/12/2018 16:49:34	1,7 % 18/12/2018 12:17:01		
<b>Avg</b>	0,85 %	1,1 %	0,92 %		
<b>Min</b>	0,68 % 18/12/2018 9:27:02	0,83 % 18/12/2018 10:45:44	0,64 % 18/12/2018 10:42:00		
<b>THD-A [%]</b>	<b>A</b>	<b>B</b>	<b>C</b>	<b>N</b>	
<b>Max</b>	4,8 % 18/12/2018 17:10:07	4,0 % 18/12/2018 17:08:39	4,4 % 18/12/2018 17:10:19		
<b>Avg</b>	1,7 %	1,6 %	2,0 %		
<b>Min</b>	0,97 % 18/12/2018 14:02:12	1,0 % 18/12/2018 14:02:17	1,2 % 18/12/2018 11:06:21		
<b>Unbalance [%]</b>	<b>AN</b>	<b>BN</b>	<b>CN</b>	<b>Total</b>	
<b>Avg</b>					

### Averaging interval:

	Configured Interval length
CHILLER 18 DECEMBER 2018	1sec

## RMS Power overview table

CHILLER 18 DECEMBER 2018

CHILLER 18 DECEMBER 2018					Logging Information
<b>Active Power [kW]</b>					
	<b>A</b>	<b>B</b>	<b>C</b>	<b>Total</b>	
<b>Max</b>	157,635 kW 18/12/2018 11:11:58	162,887 kW 18/12/2018 11:11:58	157,100 kW 18/12/2018 11:11:58	477,623 kW 18/12/2018 11:11:58	Study type: <b>Energy study</b>
<b>Avg</b>	141,623 kW	147,556 kW	141,872 kW	431,056* kW	Topology: <b>3-ph Wye</b>
<b>Min</b>	36,144 kW 18/12/2018 17:05:25	39,050 kW 18/12/2018 17:10:18	38,523 kW 18/12/2018 17:05:27	114,021 kW 18/12/2018 17:05:25	Start date: <b>18/12/2018 8:13:46</b>
<b>Apparent Power [kVA]</b>					
	<b>A</b>	<b>B</b>	<b>C</b>	<b>Total</b>	
<b>Max</b>	194,000 kVA 18/12/2018 11:11:58	204,662 kVA 18/12/2018 11:11:58	201,690 kVA 18/12/2018 11:11:58	600,536 kVA 18/12/2018 11:11:58	End date: <b>18/12/2018 17:13:46</b>
<b>Avg</b>	176,826 kVA	188,164 kVA	184,747 kVA	549,962* kVA	Duration: <b>9h 0m 0s</b>
<b>Min</b>	59,981 kVA 18/12/2018 16:59:49	65,627 kVA 18/12/2018 16:59:49	67,054 kVA 18/12/2018 17:02:35	193,586 kVA 18/12/2018 17:02:45	Averaging interval: <b>1sec</b>
<b>Non-Active Power [kvar]</b>					
	<b>A</b>	<b>B</b>	<b>C</b>	<b>Total</b>	
<b>Max</b>	113,123 kvar 18/12/2018 12:15:49	125,807 kvar 18/12/2018 12:15:26	128,345 kvar 18/12/2018 12:14:42	367,215 kvar 18/12/2018 12:15:49	Number of averaging intervals: <b>32400 (32400)</b>
<b>Avg</b>	105,879 kvar	116,760 kvar	118,338 kvar	341,540* kvar	* ... series contained invalid values that have been discarded for the shown result.
<b>Min</b>	47,335 kvar 18/12/2018 16:59:49	52,024 kvar 18/12/2018 16:59:49	54,704 kvar 18/12/2018 17:02:40	155,452 kvar 18/12/2018 16:59:49	
<b>Power Factor [1]</b>					
	<b>A</b>	<b>B</b>	<b>C</b>	<b>Total</b>	
<b>Max</b>	0,83 ind 18/12/2018 8:17:36	0,82 ind 18/12/2018 8:17:36	0,80 ind 18/12/2018 13:23:24	0,82* ind 18/12/2018 8:17:36	
<b>Avg</b>	0,80	0,78	0,77	0,78*	
<b>Min</b>	0,60 ind 18/12/2018 17:05:07	0,59 ind 18/12/2018 17:10:07	0,57 ind 18/12/2018 17:05:21	0,59* ind 18/12/2018 17:05:02	

### Averaging interval:

	Configured Interval length
CHILLER 18 DECEMBER 2018	1sec

# DENAH LANTAI 1 GEDUNG TELKOM

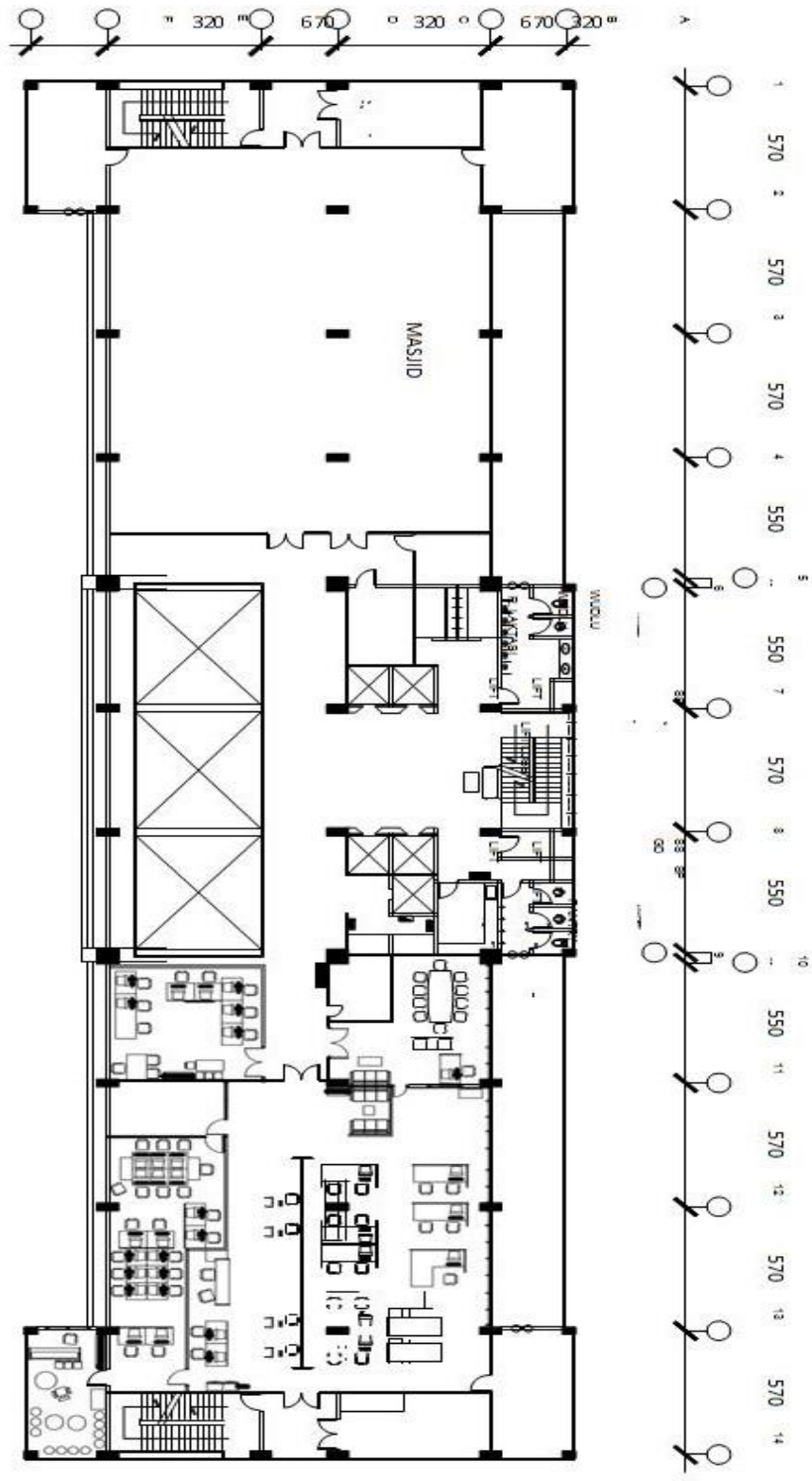



## DATA REKENING

	PT. PLN (PERSERO) UD JAWA TENGAH DAN DIY UPJ SEMARANG ULP SEMARANG TENGAH	<b>INFORMASI TAGIHAN LISTRIK</b> PT PLN (Persero) Kantor Pusat Jl Trunojoyo Blok M 1 / 135, Melawai Kelurahan Bara - Jakarta Selatan NPWP : 01.001.829.3-001.000								
Kepada Yth PT TELKOM INDONESIA  JL PAHLAWAN 10  NPWP : 00.000.000.0-000.000 No Invoice : 523010025073-0119	Id Pelanggan : 523010025073 Rekening Bulan : 01-2019 Tarif / Daya : 03 / 2.180.000 VA Tarif / Daya Lama : - / 0 VA FKM MWU/daerah/FRT : -4.000 / 4.000 / 1 FKM MWU/daerah/FRT LM : -4.000 / 4.000 / 1 Jam Nyala / Fak K : 03									
Catatan Meter	Tanggal	LWSP	WSP	TOTAL	KWaRH					
St Akhir	01-01-2019	606.300	62.000		252.965					
St Awal	01-12-2018	585.300	58.440		238.380					
Selish Stand (st akhir - st awal) * FKM * FRT		184.000.000	17.000.000		54.340.000					
Pemakaian kWh Total		184.000.000	17.000.000	191.000.000	54.340.000					
I Penyerahan Listrik										
1. Pendapatan Biaya Dibatan					Rp	0				
2. Pendapatan Biaya Pemakaian					Rp	196.280.310				
LWSP		WSP		kWh		TOTAL				
Pajak kWh	Biaya Pajak	Sub Total	Pajak kWh	Biaya Pajak	Sub Total					
A	154.000	1.035.78	189.937.820	17.000	1.555.67	20.412.300	0	1.114.74	g	196.280.310
B										
C										
D										
3. Rupiah PTL Bruto (1+2)					Rp	196.280.310				
4. Rupiah Kompensasi TMP					Rp	0				
5. Jumlah PTL Neto (3-4)					Rp	196.280.310				
6. Jumlah Rupiah Pemakaian Tenaga Listrik (PTL) yang ditagihkan					Rp	196.280.310				
7. Tagihan Lainnya					Rp	0				
8. Jumlah Rupiah Pemakaian Tenaga Listrik (PTL) (6+7)					Rp	196.280.310				
9. PPh					Rp	19.628.031				
Total Penyerahan Listrik					Rp	196.280.310				
<b>PPN DIBEBAHKAN SESUAI PP NOMOR 81 TAHUN 2015</b>										
II Pajak Penerangan Jalan (PPN) (100% x PTL Neto)					Rp	17.665.229				
III Penyerahan Non Listrik					Rp	0				
1. Sewa Trafo / Pemakaian Trafo / Sewa Kapasitor, dll					Rp	0				
2. PPh					Rp	0				
Total Penyerahan Non Listrik					Rp	0				
IV Jumlah Tagihan (I + II + III)					Rp	213.945.539				
TERDILANG										
Dua Ratus Tiga Belas Juta Sembilan Ratus Empat Puluh Lima Ribu Lima Ratus Tiga Puluh Delapan Rupiah										
Batas Akhir Masa Bayar 20 Januari 2019 Status : <b>SELUM LUNAS (11)</b> Tanggal Bayar : - Biaya Keterlambatan (SK) : Rp. 0 Tagihan belum termasuk Bea Meteral sebesar Rp. 8.000										
					SEMARANG, 03-01-2019					
					MANAJER					
Keterangan: A = Tarif Daya Baru TTL Baru B = Tarif Daya Lama TTL Baru C = Tarif Daya Baru TTL Lama D = Tarif Daya Lama TTL Lama					ZUHDAN FEBRI WIBOWO					

I. Informasi Tagihan Listrik ini berlaku sebagai dokumen tertentu yang kedudukannya dipertahankan dengan Faktur Pajak sesuai dengan Peraturan Direktur Jenderal Pajak No. PER-10/PJ/2010 sebagaimana telah diubah terakhir dengan Peraturan Direktur Jenderal Pajak No. PER-33/PJ/2014.